

Staničení je navázáno na stavbu "Oprava koleje v úseku Roztoky u Jilemnice - Martinice v Krkonoších" projektovanou v r. 2018. Dělicí bod obou staveb je v km 85,150.

Souřadnicový systém S-JTSK, Výškový systém Bpv

Vypracoval: Ing. David Derka	Zodp. projektant: Ing. David Derka	Kontroloval: Ing. Petr Burda		
Kraj: Liberecký	Traťový úsek/Obec: Kruh, Roztoky u Jilem., Martinice v Krkon.			
Investor Správa železnic, státní organizace; Dlážděná 1003/7; 110 Praha 1				
Akce: Oprava trati v úseku Roztoky u Jilemnice – Kunčice nad Labem SO 01.1 Železniční svršek v km 84,411 – 85,150			Formát	31x A4
			Datum	01/2022
			Účel	ZPD
			Č. zakázky	3110/21/058
			Změna	Č. kopie
Obsah výkresu: PRACOVNÍ PŘÍČNÉ ŘEZY km 84,425 - 85,150			Měřítko	1:100
			Část dokumentace	Č. výkresu
			D.2.1.a.1	06

PR: 1
84.425 000

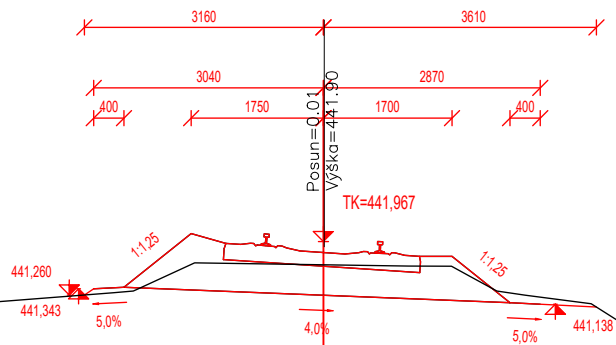

434.50



PR: 2
84.450 000

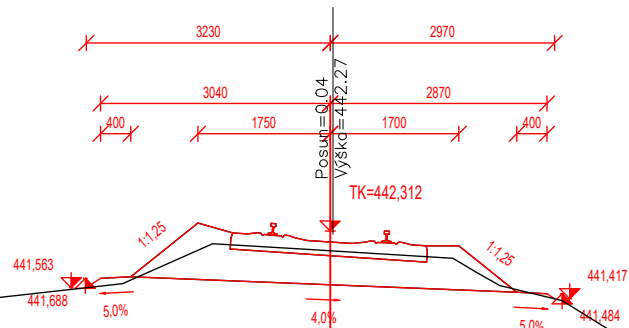

435.00

PR: 3
84.475 000

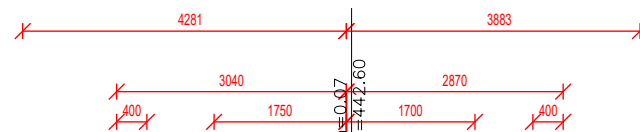

Posune=0.07
Výška=442.60

TK=442,658

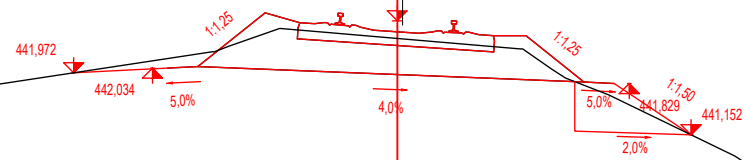

436.50



PR: 4
84.500 000

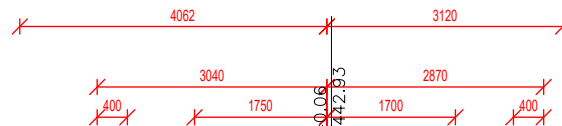

Posun=0,06
Výška=42,93

TK=443,010

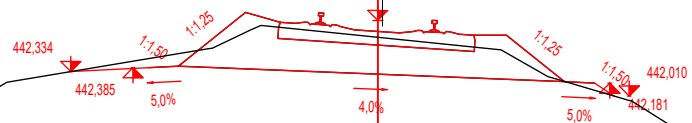

438.00

PR: 5
84.525 000

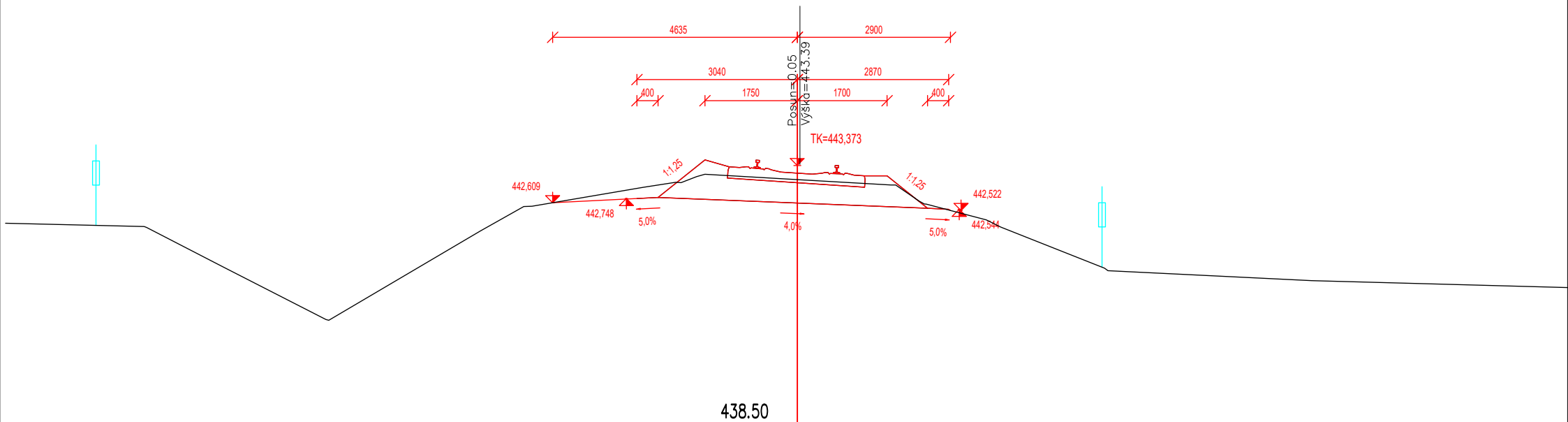

PR: 6
84.550 000

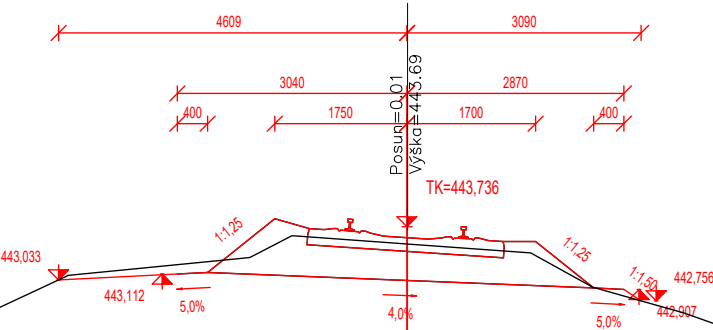

438.50

PR: 7
84.575 000

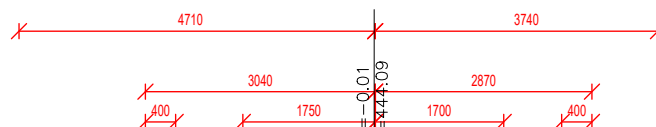

Posun = -0,01
Výška = 444,09

TK=444,099

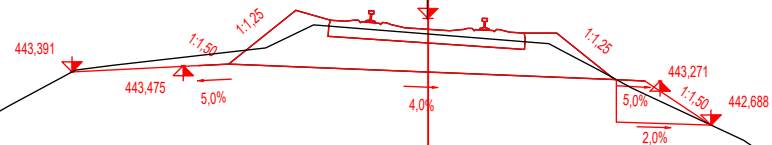

438.00

PR: 8
84.600 000

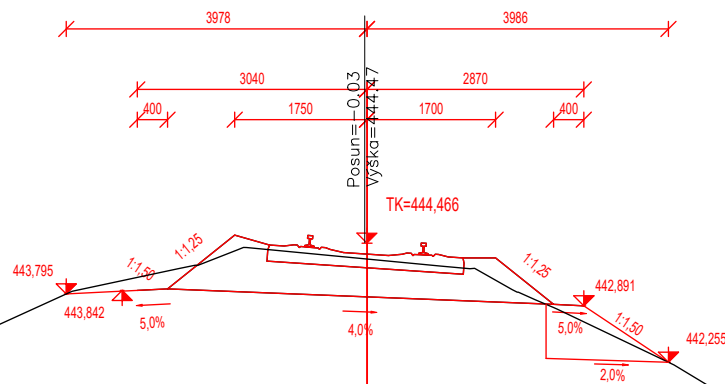

439.00

PR: 10
84.650 000

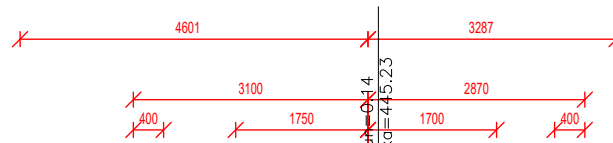

Posudek 014
Výška = 445,23

TK=445,227

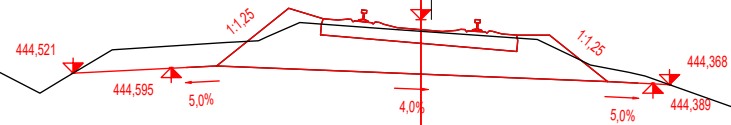

441.00

PR: 11
84.675 000

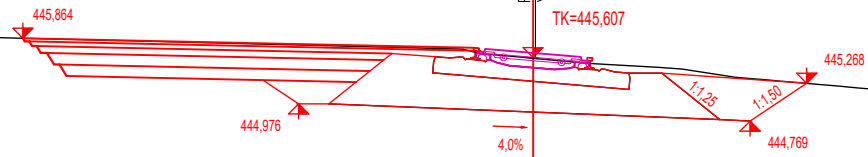
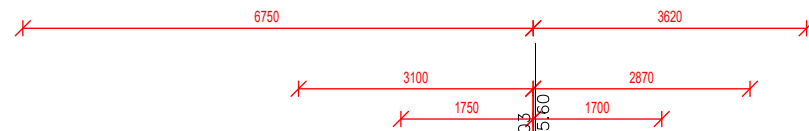

442.50

PR: 12
84.700 000

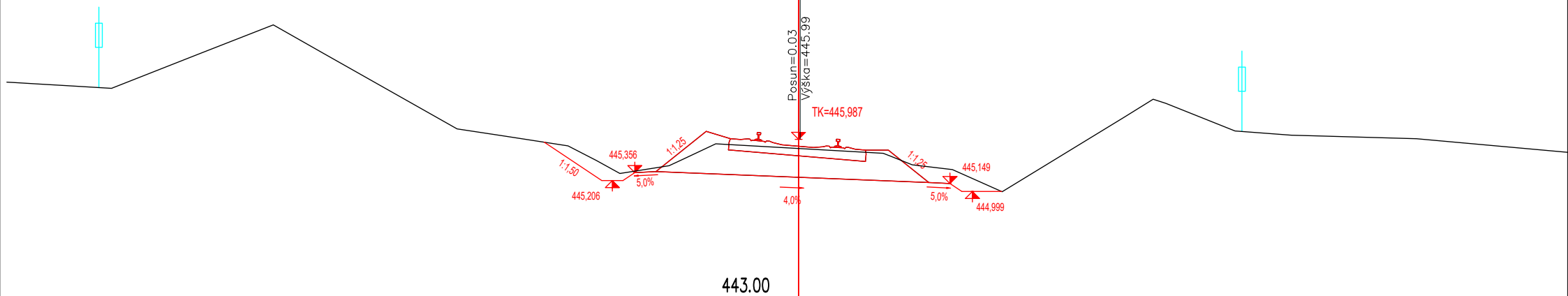
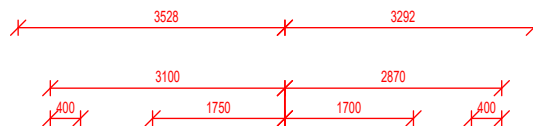

443.00

PR: 13
84.725 000

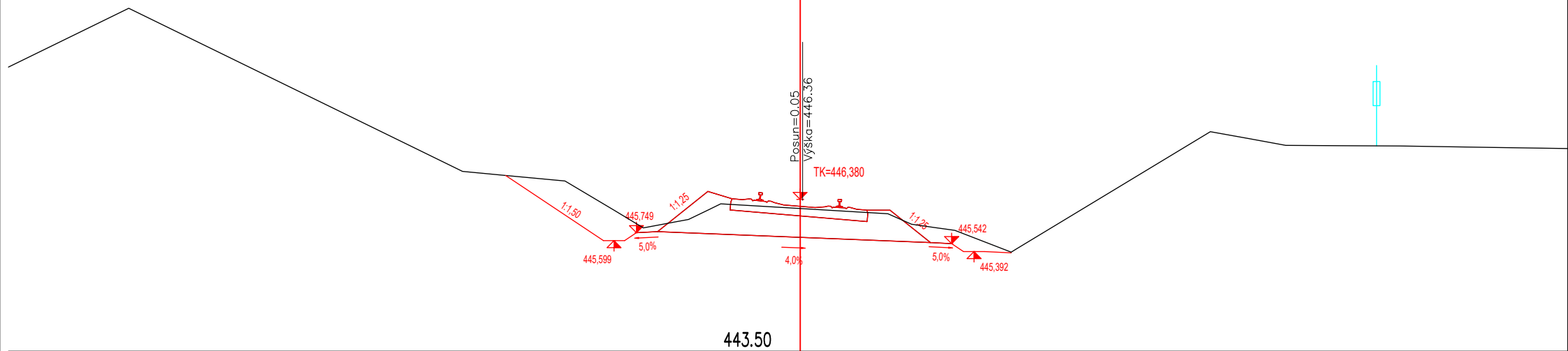
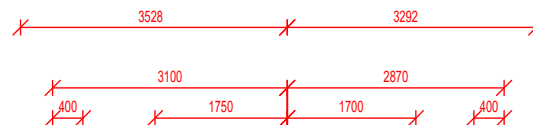

PR: 16
84.800 000

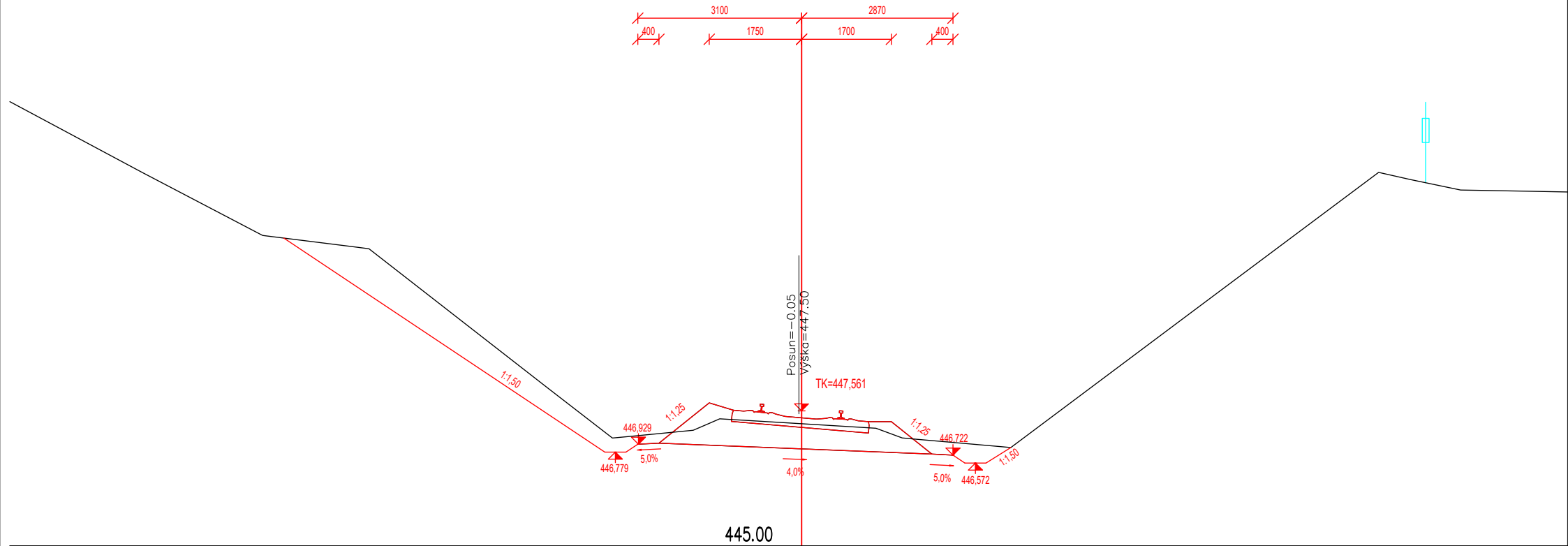

PR: 17
84.825 000



Posun = -0.07
Výška = 447.90

TK=447,954

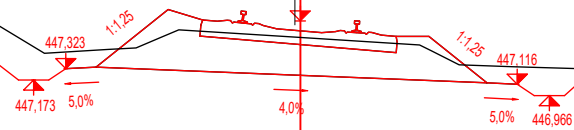

445.00

PR: 18
84.850 000

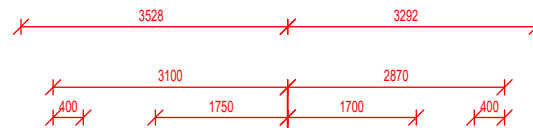

Posun = -0.15
Výška = 448.22

TK=448,347

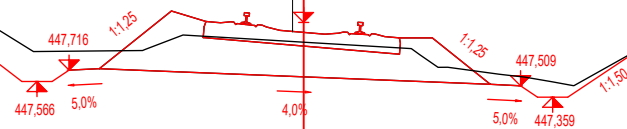

445.50

PR: 19
84.875 000

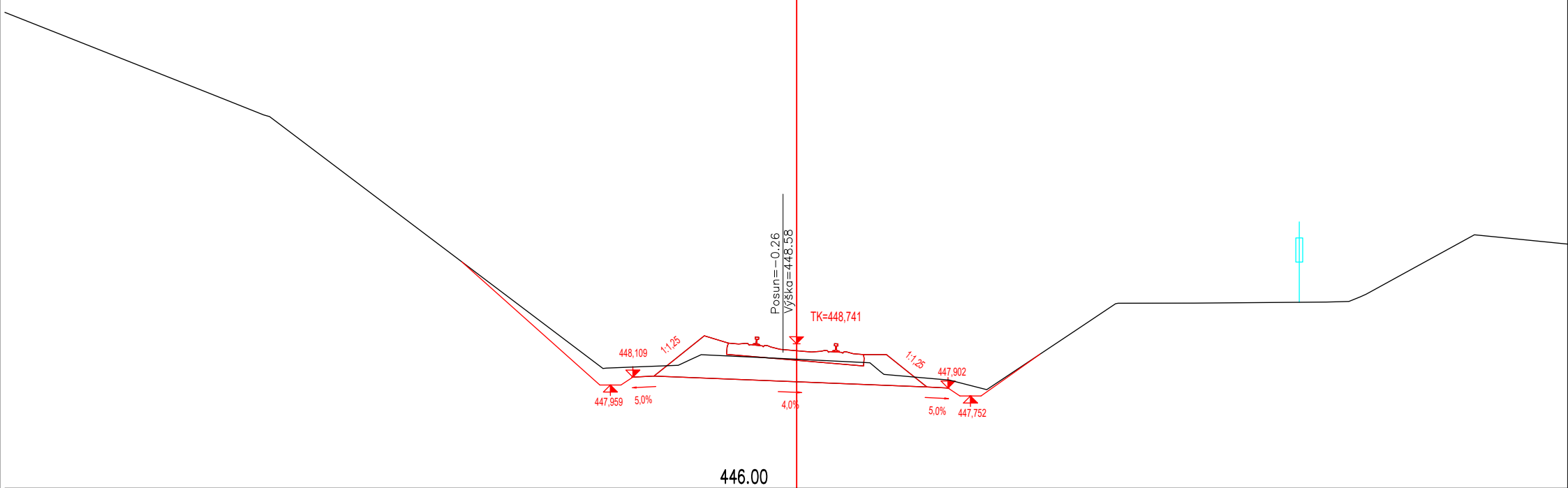
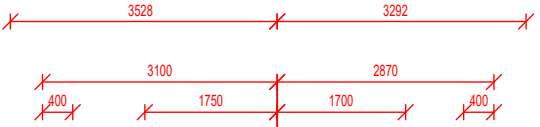

446.00

PR: 20
84.900 000

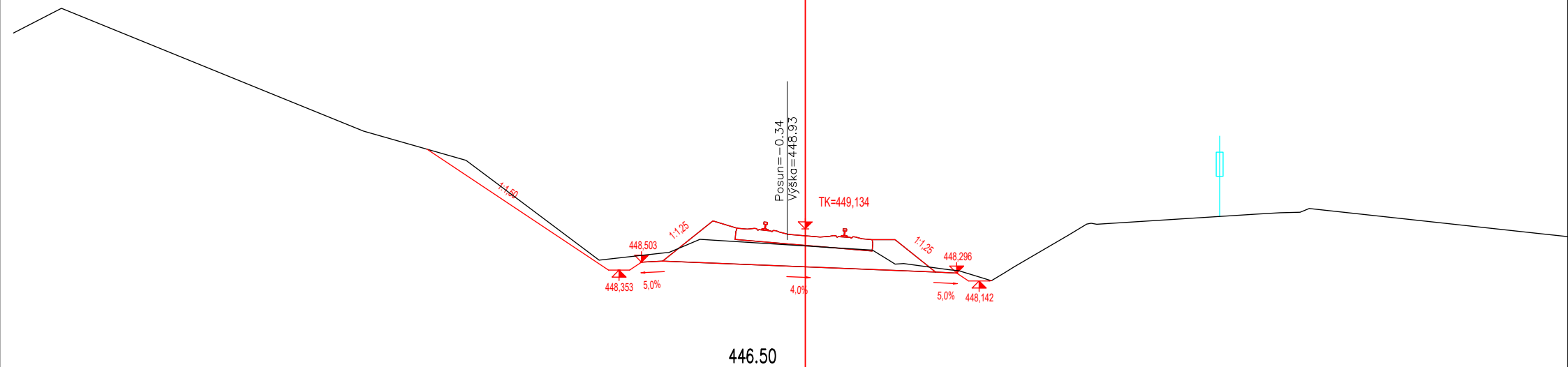
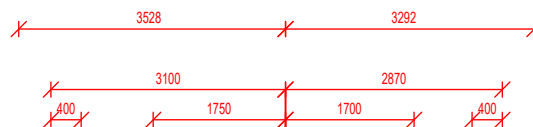

PR: 21
84.925 000

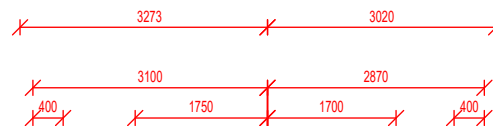

Posun = -0.36
Výška = 449.33

TK=449,527

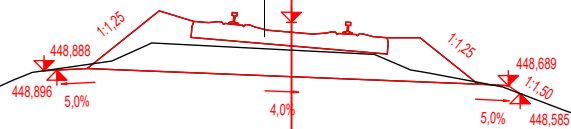

445.50

PR: 22
84.950 000

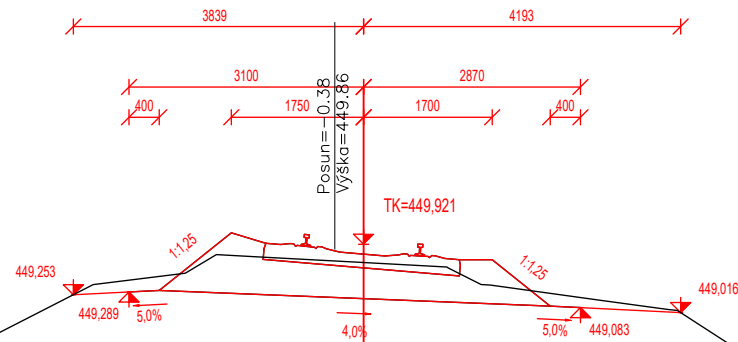

444.50

PR: 24
85.000 000

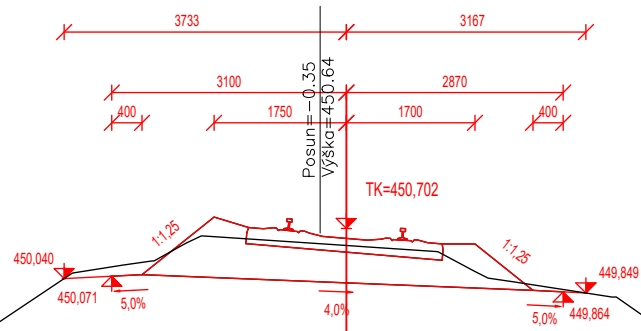

PR: 26
85.050 000

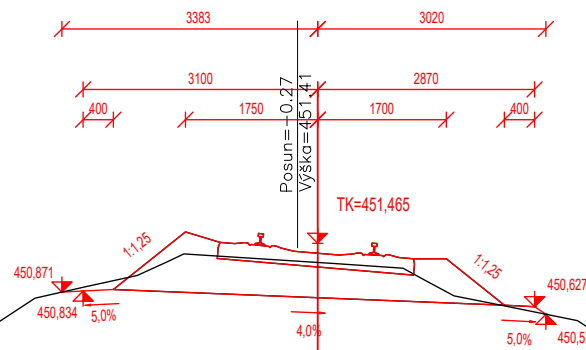

441.50

PR: 27
85.075 000

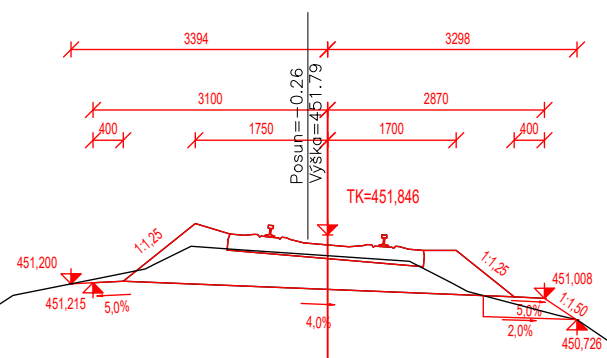

441.50

PR: 28
85.100 000

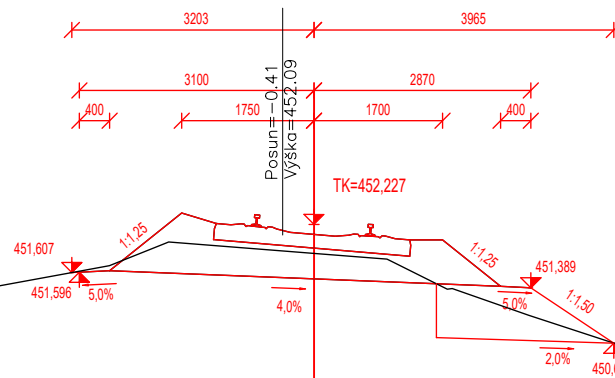

441.50

PR: 30
85.150 000

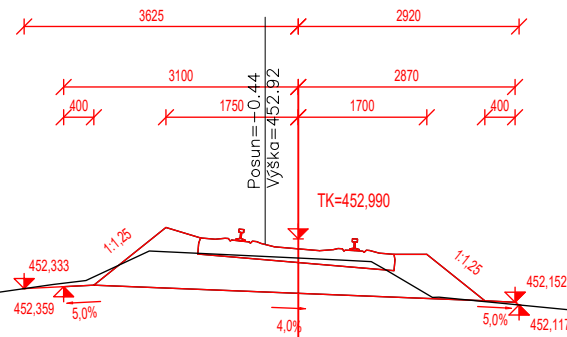

444.00